

# ELEVATION CERTIFICATE

Important: Read the instructions on pages 1-9.

OMB No. 1660-0008  
 Expiration Date: July 31, 2015

A1. Building Owner's Name: Flagship Construction, Inc.  
 A2. Building Street Address (including Apt., Unit, Suite, and/or Bldg. No.) or P.O. Route and Box No.: 805 Trey Court  
 City: Longs State: SC ZIP Code: 29568

Policy Number:  
 Company NAIC Number:

A3. Property Description (Lot and Block Numbers, Tax Parcel Number, Legal Description, etc.):  
Lot 155 Polo Farms Tax Map: 100-17-01-111

8-15-14 #30  
#38560

A4. Building Use (e.g., Residential, Non-Residential, Addition, Accessory, etc.): Residential

A5. Latitude/Longitude: Lat. N33d 55' 08.5" Long. W078d 48' 41.2" Horizontal Datum:  NAD 1927  NAD 1983

A6. Attach at least 2 photographs of the building if the Certificate is being used to obtain flood insurance.

A7. Building Diagram Number 1B

A8. For a building with a crawlspace or enclosure(s):

- a) Square footage of crawlspace or enclosure(s) N/A sq ft
- b) Number of permanent flood openings in the crawlspace or enclosure(s) within 1.0 foot above adjacent grade N/A
- c) Total net area of flood openings in A8.b N/A sq in
- d) Engineered flood openings?  Yes  No

A9. For a building with an attached garage:

- a) Square footage of attached garage 400 sq ft
- b) Number of permanent flood openings in the attached garage within 1.0 foot above adjacent grade N/A
- c) Total net area of flood openings in A9.b N/A sq in
- d) Engineered flood openings?  Yes  No

*Handwritten notes:*  
 OK  
 8-15-14

## SECTION B - FLOOD INSURANCE RATE MAP (FIRM) INFORMATION

B1. NFIP Community Name & Community Number: 450104 Horry  
 B2. County Name: Horry  
 B3. State: SC

B4. Map/Panel Number: 45051C0395  
 B5. Suffix: J  
 B6. FIRM Index Date: 9-17-2003  
 B7. FIRM Panel Effective/Revised Date: 4-28-07  
 B8. Flood Zone(s): AE  
 B9. Base Flood Elevation(s) (Zone AO, use base flood depth): 20'

B10. Indicate the source of the Base Flood Elevation (BFE) data or base flood depth entered in item B9.

- FIS Profile  FIRM  Community Determined  Other/Source: LOMR 06-04B-279P 4-26-2007

B11. Indicate elevation datum used for BFE in item B9:  NGVD 1929

- NAVD 1988  Other/Source: LOMR

B12. Is the building located in a Coastal Barrier Resources System (CBRS) area or Otherwise Protected Area (OPA)?  Yes  No  
 Designation Date: 000000  CBRS  OPA

## SECTION C - BUILDING ELEVATION INFORMATION (SURVEY REQUIRED)

C1. Building elevations are based on:  Construction Drawings\*  Building Under Construction\*  Finished Construction

\*A new Elevation Certificate will be required when construction of the building is complete.

C2. Elevations - Zones A1-A30, AE, AH, A (with BFE), VE, V1-V30, V (with BFE), AR, AR/A, AR/AE, AR/A1-A30, AR/AH, AR/AO. Complete items C2.a-h below according to the building diagram specified in item A7. In Puerto Rico only, enter meters.

Benchmark Utilized: Monument 26 266

Vertical Datum: NGVD 29

Indicate elevation datum used for the elevations in items a) through h) below.  NGVD 1929  NAVD 1988  Other/Source: LOMR

Datum used for building elevations must be the same as that used for the BFE.

Check the measurement used.

- a) Top of bottom floor (including basement, crawlspace, or enclosure floor) 21.3  feet  meters
- b) Top of the next higher floor N/A  feet  meters
- c) Bottom of the lowest horizontal structural member (V Zones only) N/A  feet  meters
- d) Attached garage (top of slab) 20.7  feet  meters
- e) Lowest elevation of machinery or equipment servicing the building (Describe type of equipment and location in Comments) 20.8  feet  meters
- f) Lowest adjacent (finished) grade next to building (LAG) 20.2  feet  meters
- g) Highest adjacent (finished) grade next to building (HAG) 20.7  feet  meters
- h) Lowest adjacent grade at lowest elevation of deck or stairs, including structural support 20.7  feet  meters

## SECTION D - SURVEYOR, ENGINEER, OR ARCHITECT CERTIFICATION

This certification is to be signed and sealed by a land surveyor, engineer, or architect authorized by law to certify elevation information. I certify that the information on this Certificate represents my best efforts to interpret the data available. I understand that any false statement may be punishable by fine or imprisonment under 18 U.S. Code, Section 1001.

- Check here if comments are provided on back of form. Were latitude and longitude in Section A provided by a licensed land surveyor?  Yes  No
- Check here if attachments.

Certifier's Name: Larry T. Beasley License Number: SCPLS 9544

Title: Land Surveyor Company Name: Beasley Land Surveying, Inc.

Address: P. O. Box 30784 City: Myrtle Beach State: SC ZIP Code: 29568

Signature: [Signature] Date: August 13, 2014 Telephone: 843-650-7722

*Handwritten signature:*  
 Larry T. Beasley

**ELEVATION CERTIFICATE** SURVEYOR, ENGINEER, OR ARCHITECT CERTIFICATION

<b>IMPORTANT: In these spaces, copy the corresponding information from Section A.</b>		<b>FOR INSURANCE COMPANY USE</b>	
Building Street Address (including Apt., Unit, Suite, and/or Bldg. No.) or P.O. Route and Box No. 805 Troy Court		Policy Number:	
City: Longs	State SC	ZIP Code 29568	Company NAIC Number:

**SECTION D - SURVEYOR, ENGINEER, OR ARCHITECT CERTIFICATION (CONTINUED)**

Copy both sides of this Elevation Certificate for (1) community official, (2) insurance agent/company, and (3) building owner.

Comments This certificate may not be used by or for any other person(s) or entities or altered. This is a final construction certificate. C2e is HVAC platform.

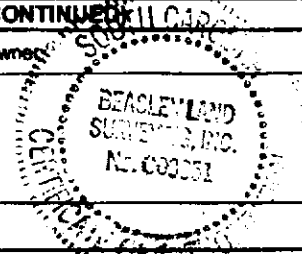

Signature: *[Handwritten Signature]* Date August 13, 2014

**SECTION E - BUILDING ELEVATION INFORMATION (SURVEY NOT REQUIRED) FOR ZONE AO AND ZONE A (WITHOUT BFE)**

For Zones AO and A (without BFE), complete Items E1-E5. If the Certificate is intended to support a LOMA or LOMR-F request, complete Sections A, B, and C. For Items E1-E4, use natural grade, if available. Check the measurement used. In Puerto Rico only, enter meters.

- E1. Provide elevation information for the following and check the appropriate boxes to show whether the elevation is above or below the highest adjacent grade (HAG) and the lowest adjacent grade (LAG).
  - a) Top of bottom floor (including basement, crawlspace, or enclosure) is \_\_\_\_\_  feet  meters  above or  below the HAG.
  - b) Top of bottom floor (including basement, crawlspace, or enclosure) is \_\_\_\_\_  feet  meters  above or  below the LAG.
- E2. For Building Diagrams 6-9 with permanent flood openings provided in Section A Items 8 and/or 9 (see pages 8-9 of Instructions), the next higher floor (elevation C2.b in the diagrams) of the building is \_\_\_\_\_  feet  meters  above or  below the HAG.
- E3. Attached garage (top of slab) is \_\_\_\_\_  feet  meters  above or  below the HAG.
- E4. Top of platform of machinery and/or equipment servicing the building is \_\_\_\_\_  feet  meters  above or  below the HAG.
- E5. Zone AO only: If no flood depth number is available, is the top of the bottom floor elevated in accordance with the community's floodplain management ordinance?  Yes  No  Unknown. The local official must certify this information in Section G.

**SECTION F - PROPERTY OWNER (OR OWNER'S REPRESENTATIVE) CERTIFICATION**

The property owner or owner's authorized representative who completes Sections A, B, and E for Zone A (without a FEMA-issued or community-issued BFE) or Zone AO must sign here. The statements in Sections A, B, and E are correct to the best of my knowledge.

Property Owner's or Owner's Authorized Representative's Name: \_\_\_\_\_

Address: \_\_\_\_\_ City: \_\_\_\_\_ State: \_\_\_\_\_ ZIP Code: \_\_\_\_\_

Signature: \_\_\_\_\_ Date: \_\_\_\_\_ Telephone: \_\_\_\_\_

Comments: \_\_\_\_\_

Check here if attachments.

**SECTION G - COMMUNITY INFORMATION (OPTIONAL)**

The local official who is authorized by law or ordinance to administer the community's floodplain management ordinance can complete Sections A, B, C (or E), and G of this Elevation Certificate. Complete the applicable item(s) and sign below. Check the measurement used in Items G8-G10. In Puerto Rico only, enter meters.

- G1.  The information in Section C was taken from other documentation that has been signed and sealed by a licensed surveyor, engineer, or architect who is authorized by law to certify elevation information. (Indicate the source and date of the elevation data in the Comments area below.)
- G2.  A community official completed Section E for a building located in Zone A (without a FEMA-issued or community-issued BFE) or Zone AO.
- G3.  The following information (Items G4-G10) is provided for community floodplain management purposes.

G4. Permit Number 00000	G5. Date Permit Issued 00/00/00	G6. Date Certificate Of Compliance/Occupancy Issued 00/00/00
----------------------------	------------------------------------	---

- G7. This permit has been issued for:  New Construction  Substantial Improvement
- G8. Elevation of as-built lowest floor (including basement) of the building: \_\_\_\_\_  feet  meters Datum: \_\_\_\_\_
- G9. BFE or (in Zone AO) depth of flooding at the building site: \_\_\_\_\_  feet  meters Datum: \_\_\_\_\_
- G10. Community's design flood elevation: \_\_\_\_\_  feet  meters Datum: \_\_\_\_\_

Local Official's Name: \_\_\_\_\_ Title: \_\_\_\_\_

Community Name: \_\_\_\_\_ Telephone: \_\_\_\_\_

Signature: \_\_\_\_\_ Date: \_\_\_\_\_

Comments: \_\_\_\_\_

Check here if attachments.



**MEMO OF REVIEW FOR CORRECTNESS AND COMPLETION**

In accordance with this community's participation in the National Flood Insurance Program's Community Rating System, all FEMA Elevation Certificates must be correct and complete. The attached Certificate has some incorrect items which are noted here.

**SECTION A - PROPERTY INFORMATION**

A1. Building Owner's Name <i>Flagship Construction, INC</i>		For Insurance Company Use: Policy Number
A2. Building Street Address (including Apt., Unit, Suite, and/or Bldg. No.) or P.O. Route and Box No. <i>805 Terry Court</i>		Company NAIC Number
City <i>Longs</i>	State <i>SC</i>	ZIP Code <i>29568</i>
A3. Property Description (Lot and Block Numbers, Tax Parcel Number, Legal Description, etc.)		

- A4. Building Use (e.g., Residential, Non-Residential, Addition, Accessory, etc.) \_\_\_\_\_
- A5. Latitude/Longitude: Lat. \_\_\_\_\_ Long. \_\_\_\_\_ Horizontal Datum:  NAD 1927  NAD 1983
- A6. Attach at least 2 photographs of the building if the Certificate is being used to obtain flood insurance.
- A7. Building Diagram Number \_\_\_\_\_
- |  |  |
|--|--|
| <p>A8. For a building with a crawl space or enclosure(s), provide</p> <p>a) Square footage of crawl space or enclosure(s) _____ sq ft</p> <p>b) No. of permanent flood openings in the crawl space or enclosure(s) walls within 1.0 foot above adjacent grade _____</p> <p>c) Total net area of flood openings in A8.b _____ sq in</p> <p>d) Engineered flood openings? <input type="checkbox"/> Yes <input type="checkbox"/> No</p> | <p>A9. For a building with an attached garage, provide:</p> <p>a) Square footage of attached garage _____ sq ft</p> <p>b) No. of permanent flood openings in the attached garage walls within 1.0 foot above adjacent grade _____</p> <p>c) Total net area of flood openings in A9.b _____ sq in</p> <p>d) Engineered flood openings? <input type="checkbox"/> Yes <input type="checkbox"/> No</p> |
|--|--|

**SECTION B - FLOOD INSURANCE RATE MAP (FIRM) INFORMATION**

B1. NFIP Community Name & Community Number		B2. County Name		B3. State	
B4. Map/Panel Number	B5. Suffix	B6. FIRM Index Date	B7. FIRM Panel Effective/Revised Date	B8. Flood Zone(s)	B9. Base Flood Elevation(s) (Zone AO, use base flood depth)

- B10. Indicate the source of the Base Flood Elevation (BFE) data or base flood depth entered in Item B9.  
 FIS Profile  FIRM  Community Determined  Other (Describe) \_\_\_\_\_
- B11. Indicate elevation datum used for BFE in Item B9:  NGVD 1929  NAVD 1988  Other/Source: \_\_\_\_\_
- B12. Is the building located in a Coastal Barrier Resources System (CBRS) area or Otherwise Protected Area (OPA)?  Yes  No  
 Designation Date \_\_\_\_\_  CBRS  OPA

**SECTION C - BUILDING ELEVATION INFORMATION (SURVEY REQUIRED)**

- C1. Building elevations are based on:  Construction Drawings\*  Building Under Construction\*  Finished Construction
- \*A new Elevation Certificate will be required when construction of the building is complete.
- C2. Elevations – Zones A1-A30, AE, AH, A (with BFE), VE, V1-V30, V (with BFE), AR, AR/A, AR/AE, AR/A1-A30, AR/AH, AR/AO. Complete items C2.a-h below according to the building diagram specified in Item A7.  
 Benchmark Utilized \_\_\_\_\_ Vertical Datum \_\_\_\_\_
- Indicate elevation datum used for the elevations in items a) through h) below.  NCVD 1929  NAVD 1988  Other

COMMENTS: *B 12 Incomplete*

Date of Review: *3/5/2015* Community Official: *Harold Edge*